

REV	DRAWING CHANGE RECORD	DATE & INITIAL
N/C	FIRST RELEASE PER CONTRACT No. _____	-/-/-
A	REMOVED SILO LADDER CAGE	03/08/22 JBM
B		-/-/-

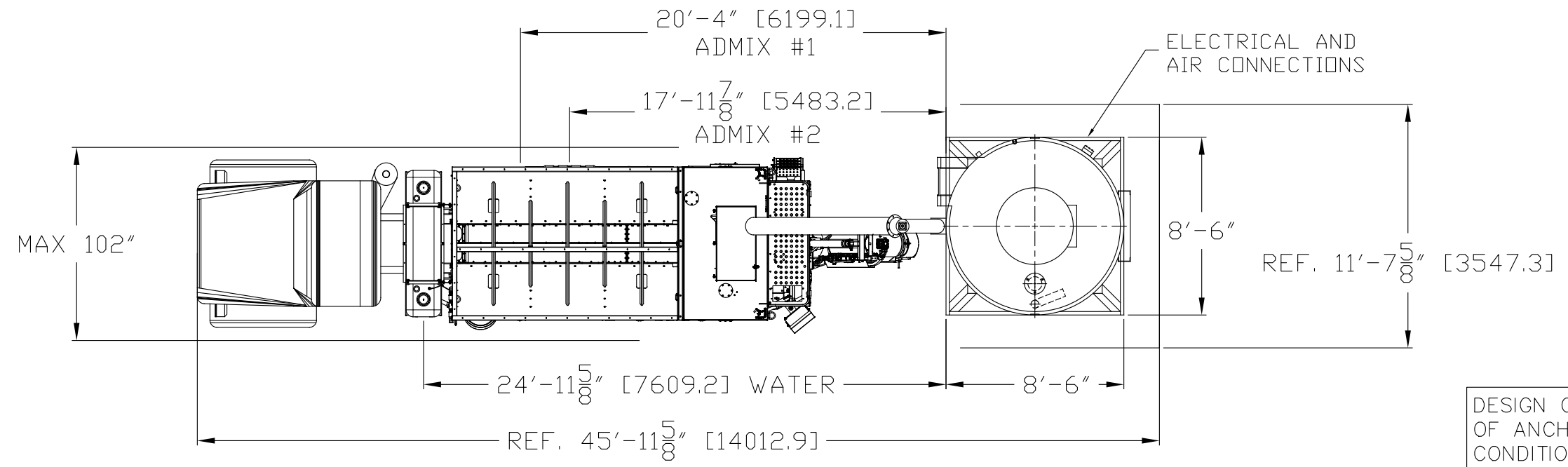

DESIGN OF CONCRETE PAD & METHOD OF ANCHORING WILL DEPEND ON LOCAL CONDITIONS SUCH AS WIND LOAD, SOIL STABILITY, ETC.

DEPENDING ON SOIL CONDITIONS, SILO MAY REQUIRE FOOTINGS @ SILO SUPPORT LOCATIONS.

CONSULT YOUR LOCAL ENGINEER FOR EXACT CONCRETE PAD DESIGN.

CONTACT CTI FOR OPTIONAL TIE DOWN KIT

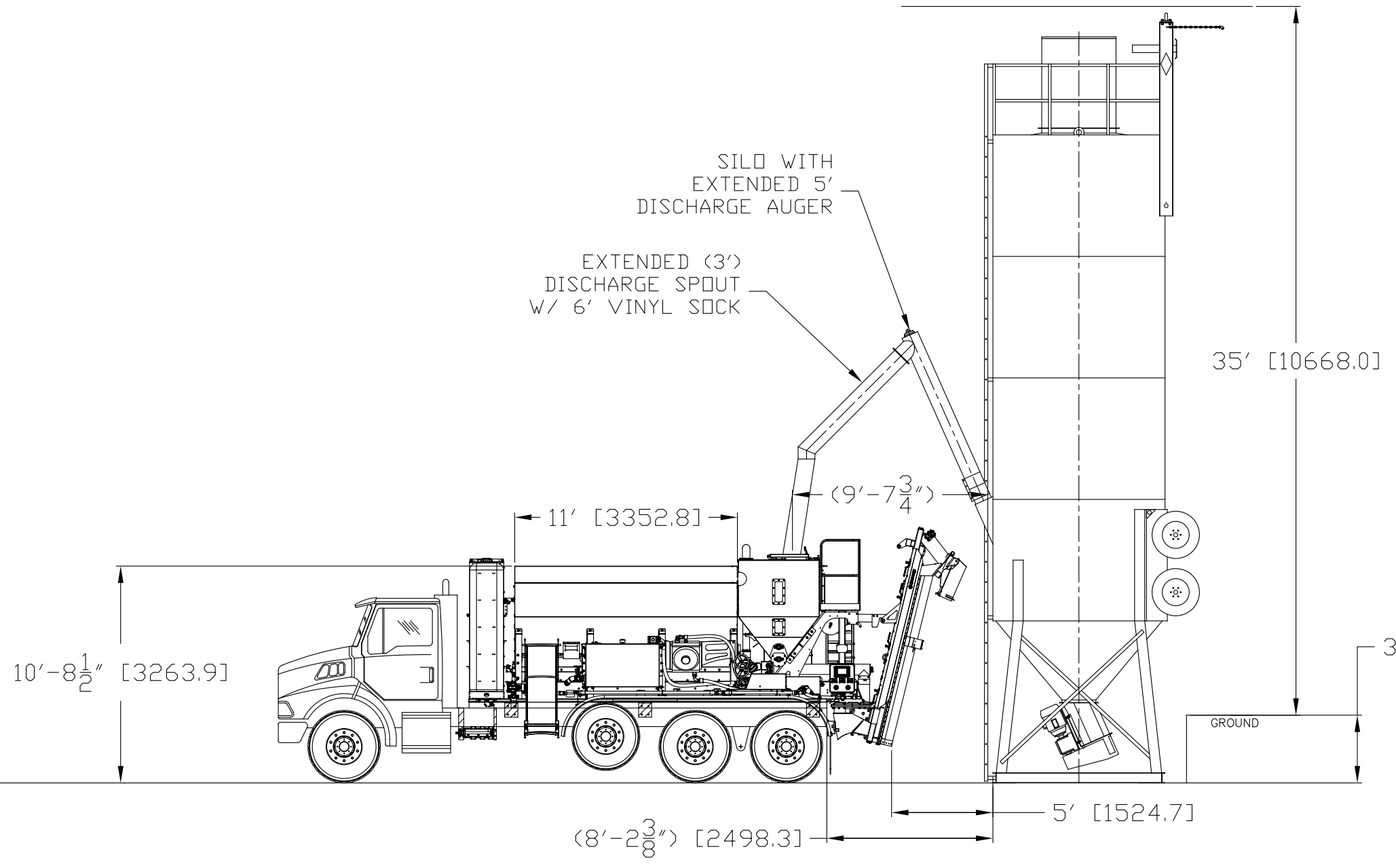

UNLESS OTHERWISE NOTED ALL DIMENSIONS ARE IN X"-X" TOLERANCES ARE:
MACHINING .XX = ±.010 X/X = ±1/32"
FABRICATION .XXX = ±.005 X' = ±1"
BREAK ALL SHARP EDGES
DEBURR ALL HOLES



SCALE: N/A	APPROVED BY:	DRAWN BY: MAW
DATE: 9/25/2018	WORK STATION:	REVISED 03/08/2022
C60 WITH 350P SILO W/ EXT AUGER		
USED IN:	DRAWING NUMBER:	REV LTR:
C60	-	A